

ICE 2V 220/50
(COD. 0600026000004)



display

Technical data

Temperature	-10°C -22°C
Voltage and Frequency	230 V~ 50 Hz
Gas	R134a
Net dimension	470 x 700 x 385 mm (l x p x h)
Packed dimension	550 x 780 x 460 mm (l x p x h)
Gross capacity	28,5 l
Net capacity	20 l
Gross weight	27.00 Kg
Net weight	24.00 Kg
Heat insulation	Rigid polyurethane foam "HCFC/CFC/HFC" free
External cabinet	White plasticised steel sheet
Cabinet bottom	Galvanized sheet
Inner tank	Stainless steel - AISI 304
Frame	White thermoformed plastic
Light box top	Shockproof plexiglas
Back grid - colour	White plasticised steel sheet
Side grid - colour	White plasticised steel sheet
Compressor	1/6 HP
absorbed power	200 W
Power consumption (24h)	1,8 kWh/24h
Condensator	Static condensation system
Evaporator	Static evaporator wrapping the tank
Defrosting	Manual
Climatic class - EN 441	4 (30°C-55%RH)
Plug	European - Angular Plug
Thermometer	Mechanical
Thermostat	Mechanical
Brand	FRAMEC
Producer brand	MONDIAL GROUP

**ICE 2V 220/50
(COD. 0600026000004)**



display

Layout

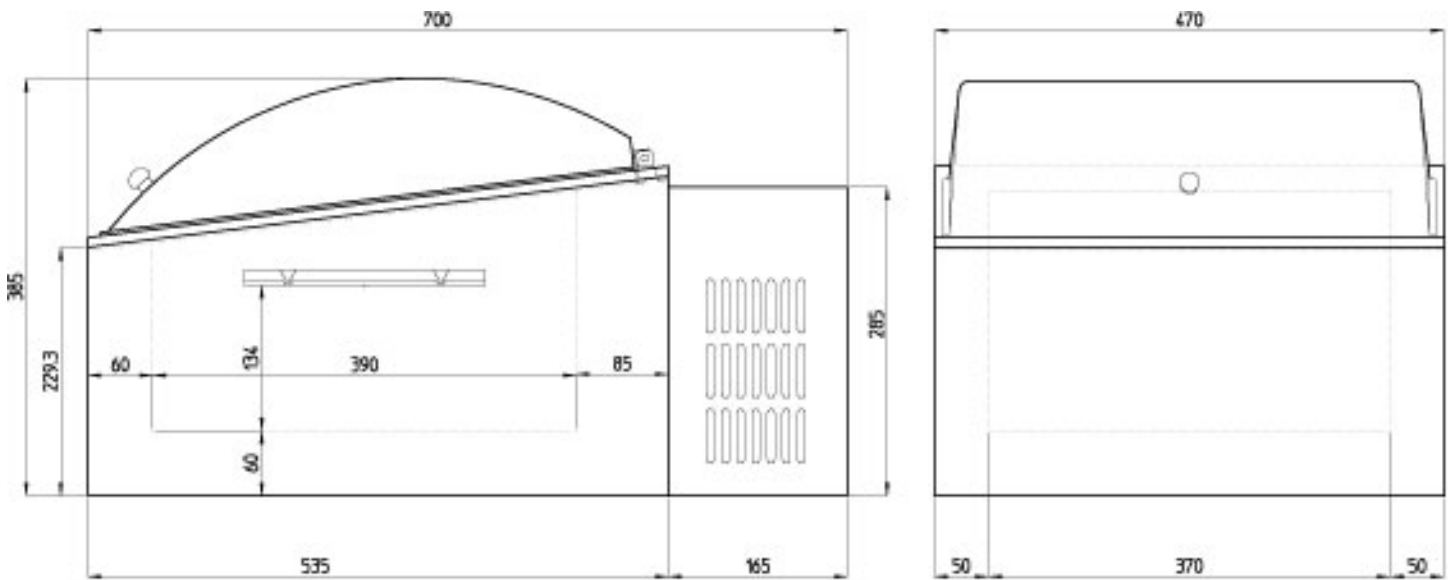

ICE 2V
S_40984 - REV.00

BINS CAPACITY: 2 x 5 l BINS

Updated on 16/06/2014

**ICE 2V 220/50
(COD. 0600026000004)**

**Mondial
Elite**

display

Image



Updated on
16/06/2014